



Heradesign®
CREATIVE

Product Data Sheet



PRODUCT PROGRAMME

Module 300/600

Triangle 300/600

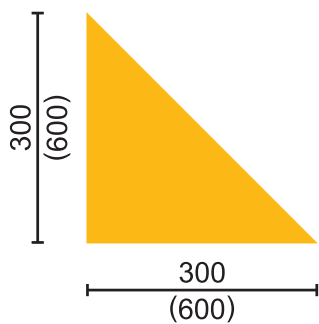

Parallelogram-L 300/600

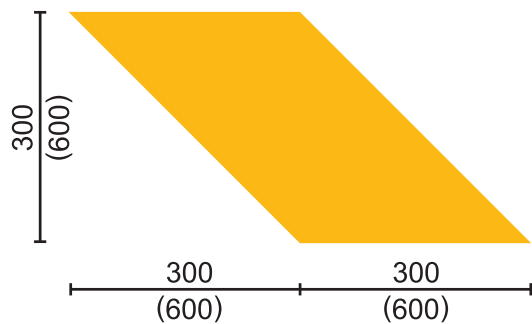

Square 300/600

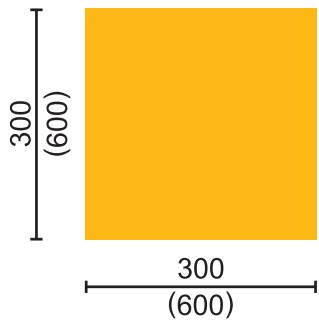

Parallelogram-R 300/600

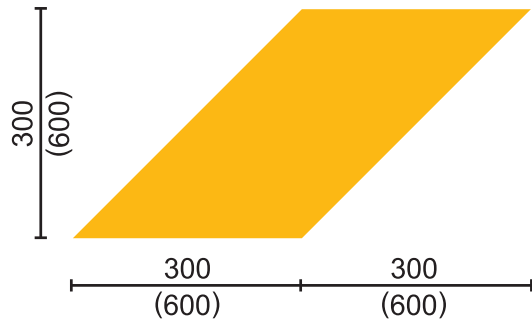

Hexagon 300/600

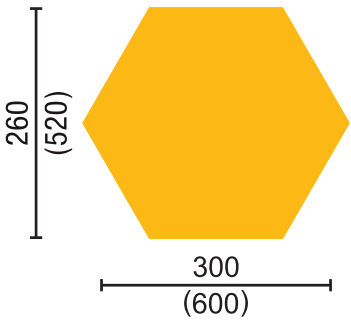

Rectangle 300/600

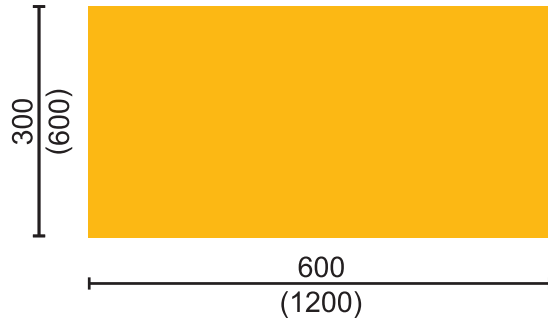

Circle 300/600

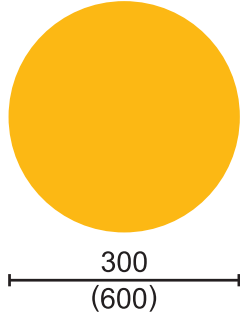

Strip 300/600

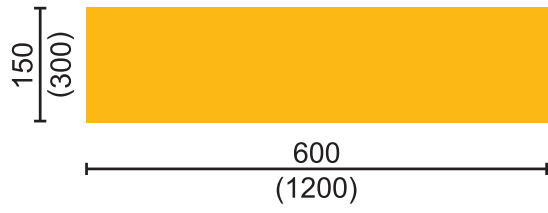

This product information corresponds to the current state of development of our products and loses its validity upon publication of a new edition. Make sure that you use the latest edition of this information. The suitability of the product is not binding for individual or special cases. Warranty and liability are based on delivery in accordance with our general terms and conditions. No responsibility or liability is accepted for the accuracy of the information provided. Version 09/2018 - JB

SURFACES AND EDGES

HERADESIGN® *fine*



1-layer magnesite bonded wood wool acoustic tile (fibre width 2 mm). Characteristic surface texture, building biology recommended.

HERADESIGN® *superfine*

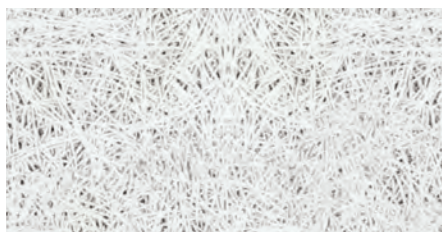

1-layer magnesite bonded wood wool acoustic tile (fibre width 1 mm). Fine surface texture, building biology recommended.

HERADESIGN® *micro*



1-layer magnesite bonded wood wool acoustic tile with a fine pore surface texture, building biology recommended.

Application areas

As decorative and acoustically effective wall claddings for use in interior areas.

Edge configuration AK-01

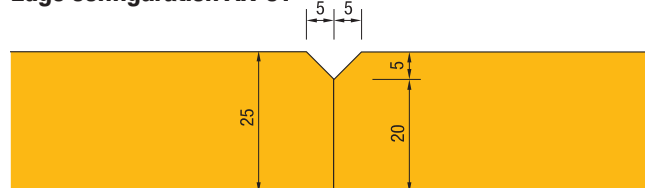

Colours

The natural surface texture of the wood wool panels is perfect for creative design and colouring. An almost unlimited range of colours is available – you can choose almost any colour from popular colour systems such as RAL, NCS or StoColor.

Standard colours	Pastel colours	Full tone colours
●	●	●

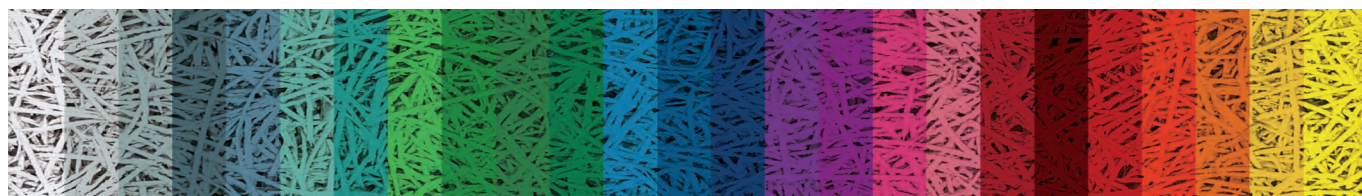

TECHNICAL DATA

Requirement per m ² of wall or ceiling area							
Description		Module 300 ¹⁾			Module 600 ²⁾		
		Area [m ²]	Pcs./m ²	Pcs./carton	Area [m ²]	Pcs./m ²	Pcs./carton
	Triangle	0.045	22.22	28	0.180	5.56	40
	Parallelogram	0.180	5.56	7	0.720	1.39	10
	Square	0.090	11.11	14	0.036	2.78	20
	Rectangle	0.180	5.56	7	0.720	1.39	10
	Strip	0.090	11.11	14	0.360	2.78	20
	Circle	0.070	11.11	14	0.283	2.78	20
	Hexagon	0.058	17.25	14	0.234	4.27	20

¹⁾ Element 300: max. 20 cartons per palette

²⁾ Element 600: max. 3 cartons per palette

INSTALLATION

Notes on installation guidelines

HERADESIGN® *creative* modules are produced, checked and transported to the construction site with great care.

When receiving the material, please always check:

- Number of package units (palettes, cartons, m²)
- Compare the contents of the package units with the delivery note and the labels on the packaging
- Accessories: plugs, screws, re-touch paint, profiles or other items
- Are the goods or parts damaged?

IMPORTANT: If there are any transport damages, insufficient quantities, or other discrepancies have this certified by the driver. Also, immediately inform the dealer that shipped the goods.

Important factors for a successful and attractive HERADESIGN® *creative* installation are exact processing and suitable working conditions. Only careful work and high product quality ensure a satisfactory result.

The installation of HERADESIGN® *creative* tiles is part of interior decorating and must only be carried out under controlled humidity and temperature conditions. All dust-causing construction measures must be completed before starting the installation.

Check the HERADESIGN® *creative* modules for damage before installation. Damaged tiles should not be installed.

Transport to site, unpacking the HERADESIGN® *creative* products and handling should always be carried out with due care. Always work with clean hands and clean tools. We recommend wearing clean gloves.

Before starting installation, check the underlying surface for loadbearing capacity.

When required, the modules can be cut using a circular saw, table saw or jigsaw. Remove any dust with a soft brush.

Slight damage to the tile surface as well as cut edges are carefully painted after installation. This is done with a fine brush. Only apply a small amount of paint to avoid colour differences. Cut edges or later produced fibres can be painted with a short-haired roller (e.g. microfibre roller 13 mm, paint roller 10 mm, etc.) or brush.



When using the HERADESIGN® *creative* modules with screw installation, we recommend HERADESIGN® Bitholder “easy” for exact installation of the screws. The required screw depth must be set on a sample tile before installation.

Variant: Screw installation on the wall

Alternatively, HERADESIGN® *creative* acoustic elements can be screw fixed onto 60 x 27 x 0.6 mm CD profiles or 30 / 60 mm wooden lathes. Screw type: HERADESIGN® screws, 50 x 4.5 mm

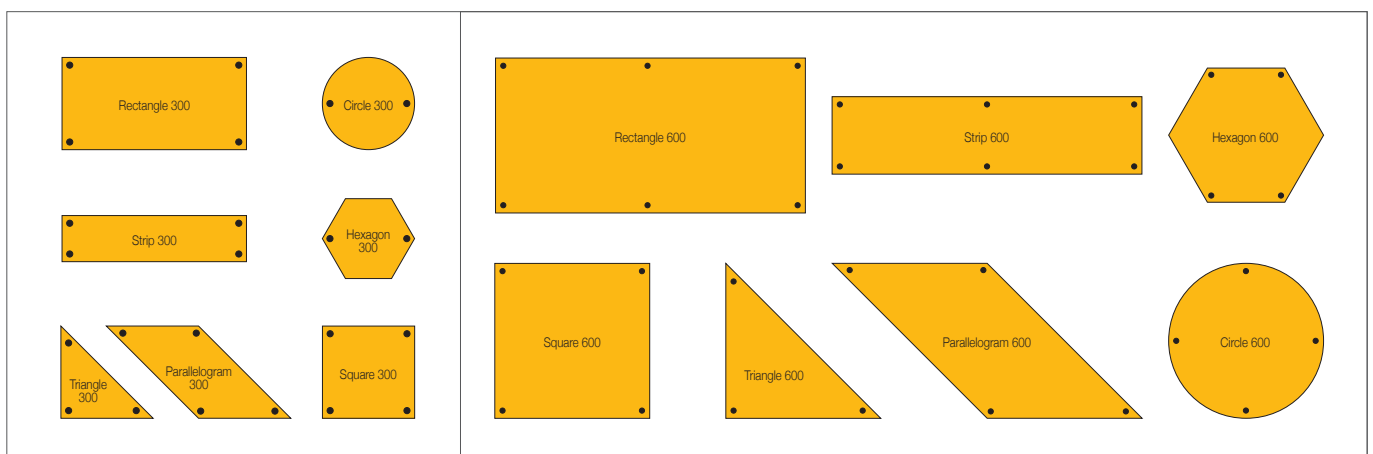

Variant: Adhesive installation on the wall

The following installation guidelines refer to the adhesive installation of HERADESIGN® *creative* acoustic elements in 300 mm modules on the wall. For installation with HERADESIGN® screws, follow the corresponding procedure.

IMPORTANT: The underlying surface must be able to take the load, level, dry and dust-free. Handling and underlying surface temperature min. +7°C. Surfaces with unknown properties should be checked for their adhesion.

The general guidelines for the installation of HERADESIGN® wood wool acoustic tiles must be observed.

1 | MARK
a horizontal guide.

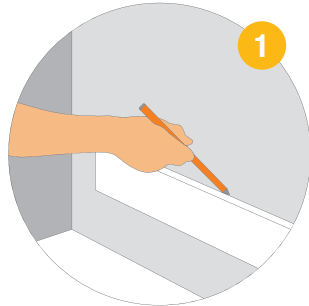

2 | MARK
a vertical guide.

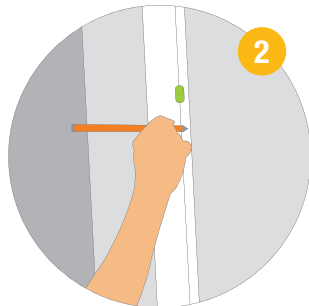

3 | DEFINE THE MODULE
Depending on the type of module to be adhered, several guides in a 300 mm or 600 mm module may be necessary.

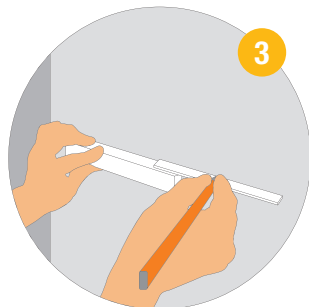

4 | APPLY ADHESIVE
Apply a line of adhesive to the acoustic element. Knauf AMF recommends using Knauf Power Adhesive.

Processing time: approx. 15 min
Amount: approx. 1 cartridge/m²

Illustrative example of the adhesive application lines.

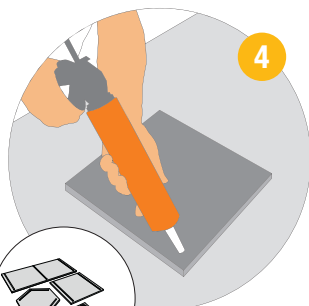

5 | ALIGN
the elements to the module and adhere to the underlying surface by applying pressure.



6 | INSTALL THE FIRST ROW

The first row must be installed with high accuracy. To ensure the elements don't slip and to ease alignment we recommend using a horizontal stop bar. Alternatively, the first row can be secured with screws or wall tacks.

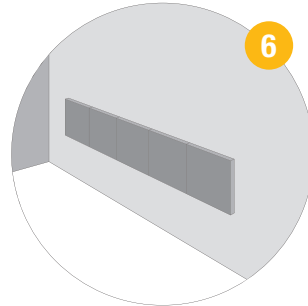

7 | FURTHER ADHESIVE

The next rows from the bottom are positioned and adhered. The position of the elements should be checked at regular intervals with a spirit level.

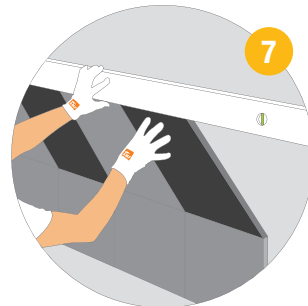

8 | CHECK

After completion, any colour damage or fibre breakage may be improved with a small brush and the supplied repair paint.

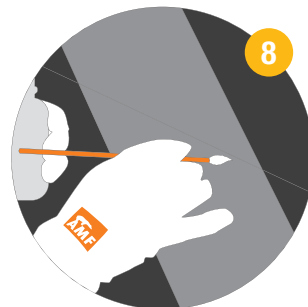

9 | ENJOY

Completed wall installation

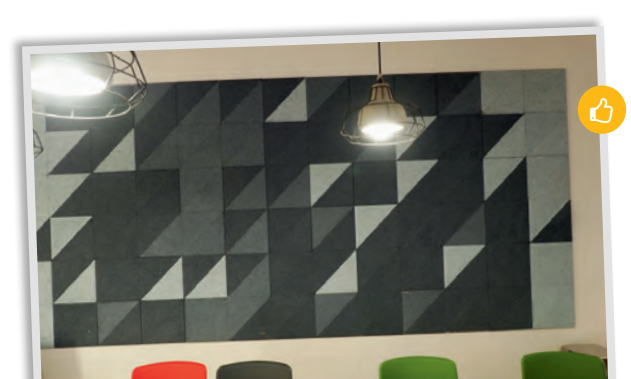
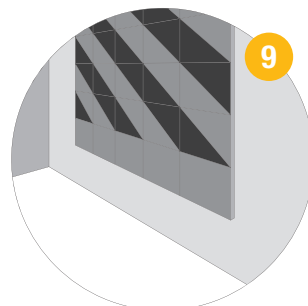



Service, Support, Logistics – Centre of expertise in Europe and on-site sales networks worldwide



The acoustic ceiling specialist Knauf AMF, with its global sales and service network, offers on-site, solution orientated and timely advice for architects, specialist contractors, distributors and developers.

With us, you are always a ceiling solution ahead!

No responsibility or liability is accepted for the accuracy of the information provided.
Subject to change without prior notice.

07/2018

Knauf AMF GmbH & Co. KG
Elsenthal 15, 94481 Grafenau
Germany

Tel.: +49 8552 422-0

Fax: +49 8552 422-32

info@knaufamf.com

www.knaufamf.com

Knauf AMF Deckensysteme GmbH
9702 Ferndorf 29
Austria
Tel.: +43 4245 2001-0
office@heradesign.co
www.heradesign.com

Knauf AMF GmbH & Co. KG
Metallstraße 1, 41751 Viersen
Deutschland
Tel.: +49 2162 957-0
info@knaufamf.com

Knauf AMF Plafonds et Systèmes
9, rue des Livraindières, 28100 Dreux
Frankreich
Tel.: +33 237 3850-50
info@knaufamf.com

Knauf AMF Ceilings Ltd.
1 Swan Road, South West Industrial Estate,
Peterlee, Co. Durham, SR8 2HS
Großbritannien
Tel.: +44 191 5188600
info-uk@knaufamf.co.uk